

ORDER FORM

- Please fill out a separate order form for each cab interior that is different in size, design or color. For same size cabs – measure each cab to ensure dimensions are identical.
- A supervisor should check for accuracy and initial each page.
- Before filling out this form please watch the measuring video on the SnapCab CD Rom.

THE FOLLOWING 3 STEPS MUST BE COMPLETED FOR YOUR ORDER TO BE PROCESSED

Step 1 – Complete the entire order form and submit to your SnapCab representative.

WARNING: Do not modify the order form drawings in any way. If necessary, supplement the order form with photos and/or drawings to show special conditions.

Step 2 – Immediately call to review your order form for accuracy and completeness.

WARNING: This step is mandatory for order processing. Delay in this step will delay your order.

Step 3 – Review, sign and return order confirmation (non-scaled drawings) - usually sent out 5-10 business days after order is processed by engineering.

Date: _____ How did you hear about SnapCab? _____

Did you speak with a SnapCab representative? Name: _____

Did you receive a quote for this project? Quote # _____

CONTRACTOR INFORMATION

Company: _____ PO#: _____

Name: _____ Field Supervisor: _____

Is this your first order? Yes No Mobile Phone: _____

Address: _____

Phone: _____ Fax: _____ E-Mail: _____

SHIPPING/CUSTOMER (BUILDING) INFORMATION

Job Name: _____

Job Address: _____

Building Type: Medical Residential Office Bldg Educational Hotel Other _____

Shipping Notification Contact: _____ Mobile Phone: _____

Ship to my office address

Lift Gate (additional cost)

Ship to the project address

Note: Crate can be easily unloaded by hand - See SnapCab video.

EXISTING CAB INFORMATION

1. **Quantity of cabs:** _____ Passenger car Freight car

Cab Identification Number(s): _____

2. **Cab Construction:** Steel Shell Wood Frame (Stick Construction)

3. **Cab Weight Capacity:** 2000 lbs 2500 lbs 3000 lbs
 3500 lbs 4000 lbs 4500 lbs 5000 lbs Other _____ lbs

4. **Cab Layout:**

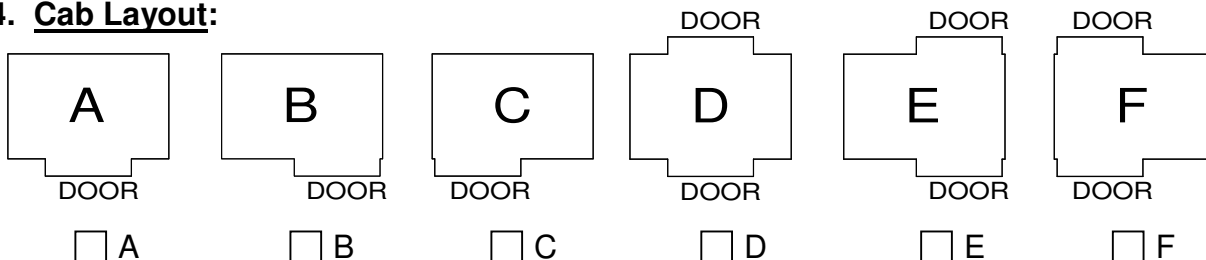

5. **Existing Cab Dimensions:** illustration below:

Note: Measurements should be taken from job site, not from drawings. Please fill in all lettered dimensions to 1/16th-inch accuracy. Provide dimensions for inside cab shell, **with existing wall panels removed.**

Inside cab width	A	_____
Inside cab depth	B	_____
Inside cab depth	C	_____
Inside cab height <u>floor to cab canopy</u>	D	_____
Inside cab height <u>floor to drop ceiling</u>	D.1	_____

Provide existing suspended ceiling dimensions even if ceiling will be removed:

Suspended ceiling width	E	_____
Suspended ceiling depth	F	_____

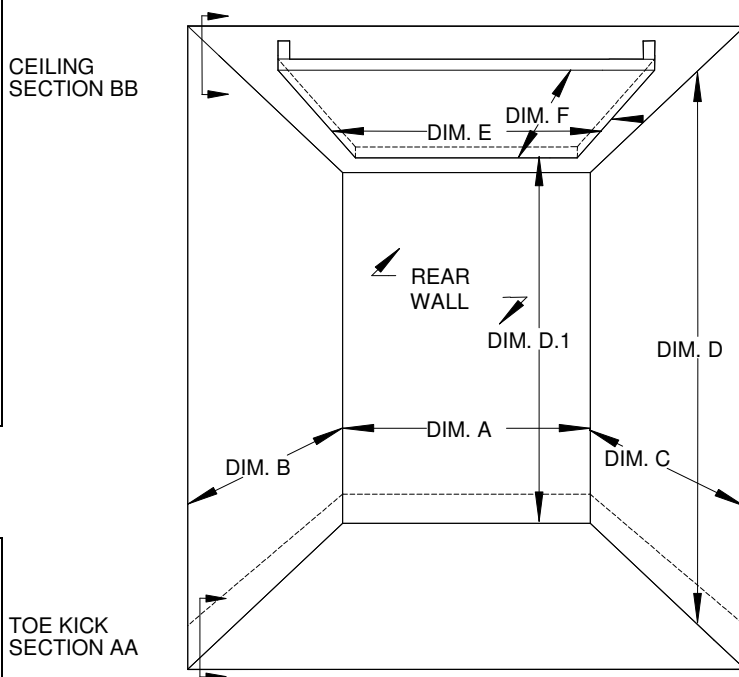

Note: If custom vented toe kicks are needed, please call. (standard toe kicks have hidden venting). For cabs with radius (rounded) corners, please call.

5A. Existing Toe Kick: Section AA Check here if existing toe kick to remain.

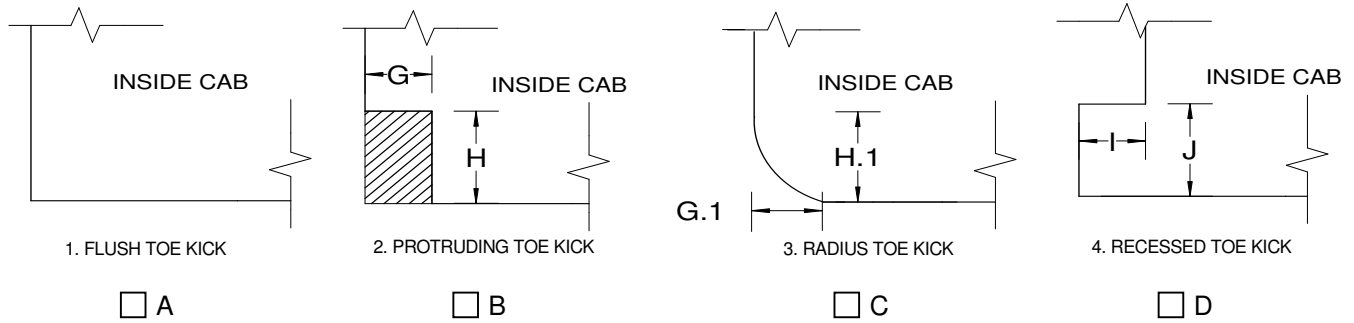

Circle detail showing how base will look after any existing toe kicks / panels are removed.

Protrusion depth **G** _____ Radius depth **G.1** _____ Recess depth **I** _____
 Toe kick height **H** _____ Radius height **H.1** _____ Recess height **J** _____

5B. Existing Ceiling: Section BB Check here if existing suspended ceiling to remain.

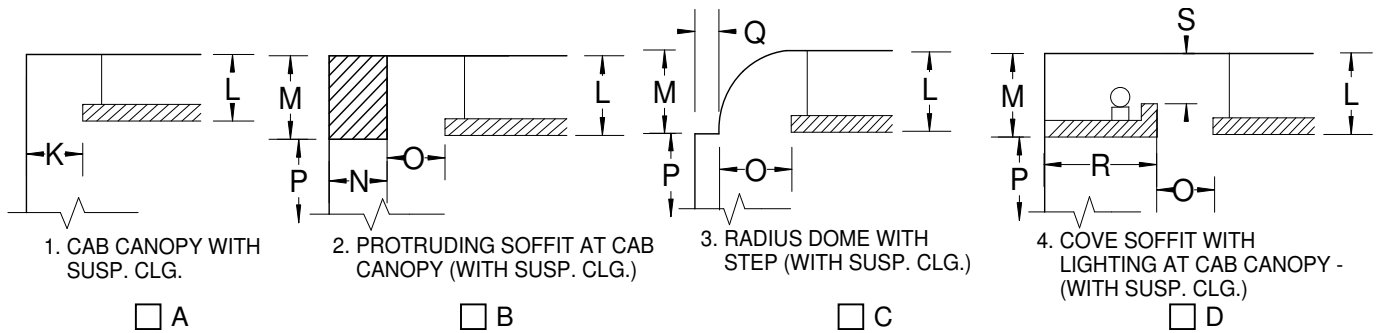

Circle detail showing how ceiling will look after any existing coves / soffits are removed.

Gap between ceiling and **cab shell K** _____ Floor to base of soffit / step / cove **P** _____
 Bottom of ceiling to canopy **L*** _____ Step width **Q** _____
 Soffit / radius / cove height **M** _____ Cove depth **R** _____
 Soffit width **N** _____ Cove gap height **S** _____
 Gap between ceiling and soffit / cove **O** _____

* Please provide ceiling drop, even if not ordering a new ceiling.

5C. Existing Protruding Soffit or Cove Lights:

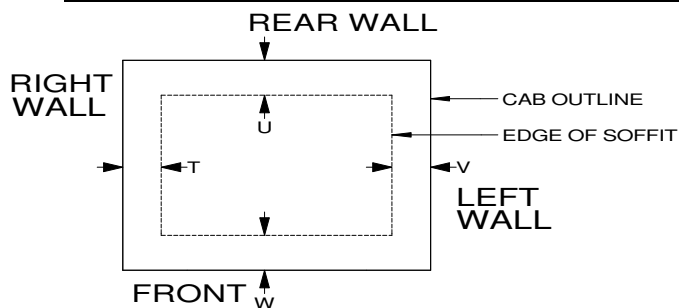

T _____
U _____
V _____
W _____

Supervisor's Initials _____

6. Exit Hatch Location:

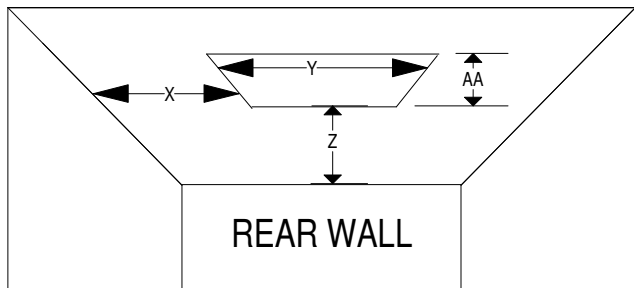

Right wall to exit hatch **X** _____
 Exit hatch width **Y** _____
 Rear wall to exit hatch **Z** _____
 Exit hatch depth **AA** _____

Will the new suspended ceiling exit hatch need to be removable from inside the car?

Yes No N/A

7. Front Wall: Check drawing that applies.

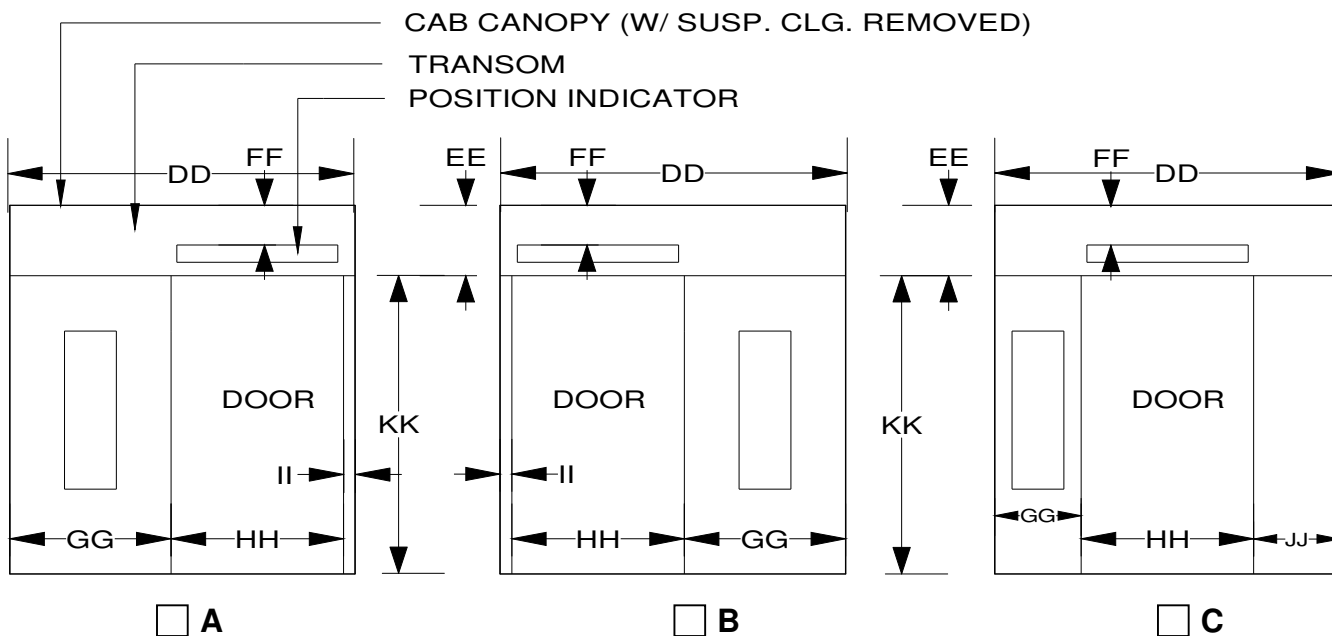

Front Dimensions (MUST BE COMPLETED FOR ALL ORDERS!):

Does the transom protrude into the cab? Yes No If yes, how far? _____

Which wall(s) is the COP located in? Left return wall Right return wall Side wall

Transom width **DD** _____

Door width **HH** _____

Transom height **EE** _____

Door frame **II** _____

Position indicator to cab canopy **FF** _____

Return wall # 2 **JJ** _____

Return wall **GG** _____

Door opening **KK** _____

NEW INTERIOR INFORMATION

1. New Wall Panels:

- Rear wall
- Left wall
- Right wall
- Left return wall
- Right return wall
- No wall panels

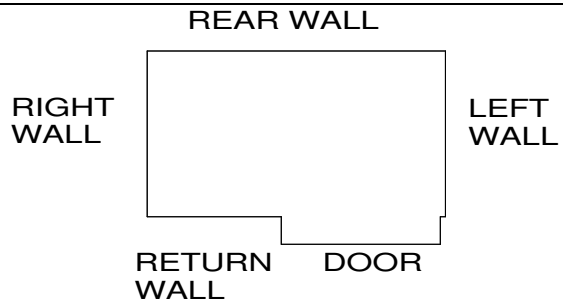

2. Wall Panel Design and Colors:

- Modern (write surface materials below)
- Classic I (write surface materials below)
- Classic II (write surface materials below)
- Contemporary (write surface materials below)
- Ultra (write surface materials below)
- Reflections (write surface materials below)
- Apex (write surface materials below)
- Summit (write surface materials below)
- Industrial (satin or textured stainless steel – write choices below)
- Sierra (write surface materials below)
- Aria (write surface materials below)
- Traditional Classic cherry wood carvings Mirrors on rear wall Mirrors on side walls
- Traditional cherry wood carvings Mirrors on rear wall Mirrors on side walls
- Milano (write surface materials below)
- Executive (write surface materials below)

Panel section	Finish / Surface Materials Choices (provide pattern name and #)
(if applicable) Layer 6	
Layer 5	
Layer 4	
(handrail layer) Layer 3	
Layer 2	
(toe kick) Layer 1	

3. Suspended Ceiling Options:

New Ceiling Yes No

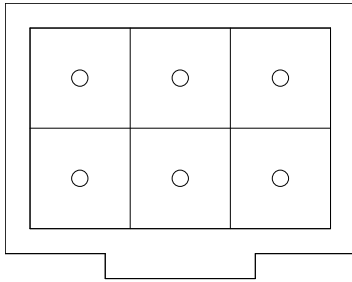

Island Downlight Ceiling
 Solid panel ceiling divided into 6 sections (9 on larger cabs) with low voltage halogen downlight centered in each section.

Stainless Steel # 4 (satin) # 8 (mirror)
Bronze # 4 (satin) # 8 (mirror)

Brushed aluminum laminate
 Bronze tone aluminum laminate
 Other laminate _____

Lighting Upgrades: Extra set of bulbs

Compact Fluorescent Incandescent LED

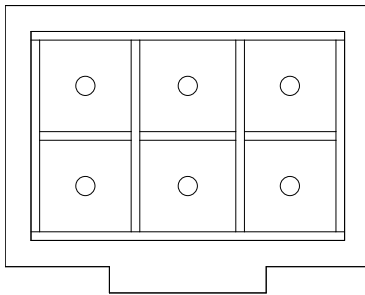

Modular Downlight Ceiling
 Aluminum frame divided into 6 sections (9 on larger cabs) with solid drop-in panels. Each panel includes halogen downlight.

Glossy black plastic laminate (Recommended)
 Brushed aluminum laminate
 Bronze tone aluminum laminate
 Other laminate _____

Lighting Upgrades: Extra set of bulbs LED

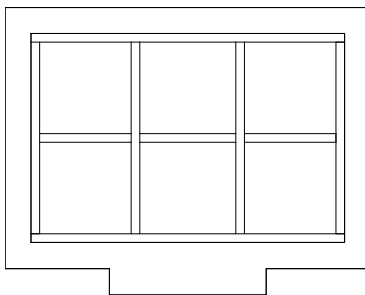

Frame Ceiling
 Aluminum frame divided into 6 sections (9 on larger cabs) with light diffusing panel in each section.

Translucent light diffusers
 Aluminum eggcrate light diffusers

Available Options:

Fluorescent light kit
 Trash guard (clear lip above perimeter prevents trash from being thrown above ceiling)

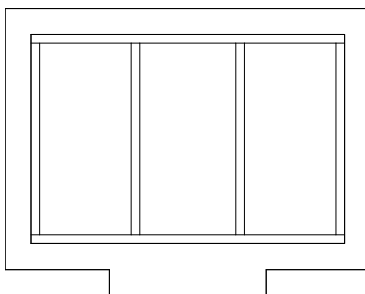

Economy Frame Ceiling
 Aluminum frame divided into 3 sections (4 or 5 on larger cabs) with light diffusing panel in each section.

Translucent light diffusers

Available Options:

Fluorescent light kit
 Trash guard (clear lip above perimeter prevents trash from being thrown above ceiling)

4. Elevator Pad Buttons: pre-installed; every 12" on center

Yes No Stainless Steel Bronze Number of sets needed: _____

5. Vinyl Elevator Pads: 3 pads per set

Yes No Grey Tan Number of sets needed: _____

6. Corner Reveals:

Satin Stainless Steel Satin Bronze (extra cost) Black Plastic No Reveals

7. Handrails:

Yes No Handrails are pre-installed on wall panels 32" from floor to top of rail unless requested otherwise. Handrail ends return to wall.

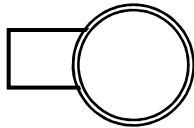

Satin stainless steel
 Mirror stainless steel
 Satin bronze
 Mirror bronze

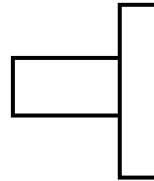

Satin stainless steel
 Mirror stainless steel
 Satin bronze
 Mirror bronze

1 1/2" diameter tubular 3/8" x 2" rectangular 1/4" x 6" rectangular
 2" diameter tubular 3/8" x 4" rectangular 1/4" x 8" rectangular

New handrails on: Rear wall Left wall Right wall

8. Bumpers:

Yes No Bumpers are pre-installed on wall panels 12" from floor to top of bumper unless requested otherwise. Bumper ends return to wall.

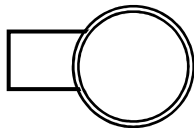

Satin stainless steel
 Mirror stainless steel
 Satin bronze
 Mirror bronze

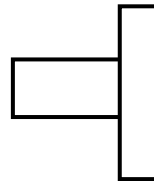

Satin stainless steel
 Mirror stainless steel
 Satin bronze
 Mirror bronze

1 1/2" diameter tubular 3/8" x 2" rectangular 1/4" x 6" rectangular
 2" diameter tubular 3/8" x 4" rectangular 1/4" x 8" rectangular

New bumpers on: Rear wall Left wall Right wall

PLEASE SEND THIS ORDER FORM TO:

FAX: 877-855-3714
EMAIL: sales@snapcabs.com
MAIL: 175 Titus Avenue, Suite 200
 Warrington, PA 18976

WEIGHT CHART – KEEP FOR YOUR RECORDS

Wall Panels – 3 walls	Cab capacity						
	2000 lb	2500 lb	3000 lb	3500 lb	4000 lb	4500 lb	5000 lb
Weight does not include reveals or handrails							
Modern, Classic I, Classic II, Contemporary or Ultra	416	442	472	516	619	627	679
Lightweight models	158	168	180	193	235	238	258
Reflections	453	479	509	553	656	664	716
Apex	472	498	528	572	675	683	735
Summit	528	554	584	628	731	739	791
Industrial	624	663	707	770	928	939	1017
Sierra	401	427	457	501	604	612	664
Aria	457	483	513	557	660	668	720
Traditional Classic	390	414	441	483	579	586	635
Traditional Classic w/ Mirrors	427	451	478	520	616	623	672
Traditional	373	396	423	463	555	562	608
Traditional w/ Mirrors	410	433	460	500	592	599	645
Milano	542	576	615	668	806	816	884
Executive	458	489	524	568	700	709	770
Ceilings	2000 lb	2500 lb	3000 lb	3500 lb	4000 lb	4500 lb	5000 lb
Island Downlight w/ stainless	119	139	153	178	208	223	248
Island Downlight w/ laminate	77	90	99	115	134	144	160
Modular Downlight	54	63	70	81	95	101	113
Frame or Economy Frame	24	28	31	36	42	45	50